

# Clearblue®

## Pregnancy Test

### RAPID DETECTION

Clearblue® Rapid Detection is a fast and easy-to-use pregnancy test which is more than 99% accurate when used from the day you expect your period to start\*.

**Please read these instructions carefully before taking a test.**

#### Before you begin

You may find it helpful to have a watch or clock with you when taking the test.

#### 1 Taking a test

If testing from the day of your expected period, you can test any time of the day.

If testing early, use the first urine of the day (see **Q3** for when to test).

- When you are ready to test, remove the test stick from the foil wrapper and take off the blue cap.
- Use the test stick straight away.

#### Test in your urine

You can test directly in your urine stream, **or** in a sample of your urine collected in a clean, dry container.

- Hold the Color Change Tip pointing downwards in either your urine stream, **or** in your collected urine sample, as shown, for **5 seconds**.



- The Color Change Tip will instantly turn pink showing that urine is being absorbed.

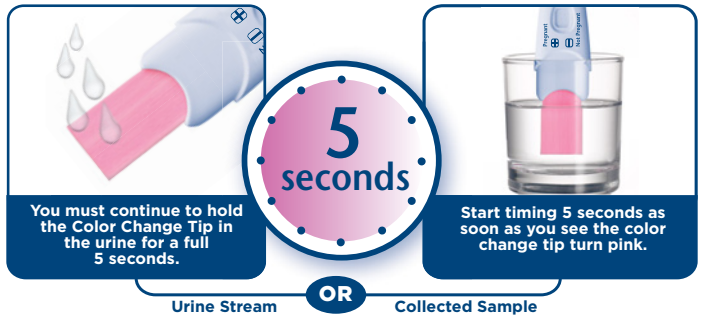

- After sampling replace the cap and lay the test stick flat.

Refer to **Q6** in Q&A if the Color Change Tip has not turned completely pink.

#### 2 WAIT. As the test begins to work you will see blue lines start to develop.

3 minutes

#### 3 Reading your result after 3 minutes

Read your result in the Result Window.

- A 'Pregnant' result may appear in 1 minute when testing from your missed period (which is the day after your expected period).
- Wait for 3 minutes to confirm a 'Not Pregnant' result or when testing before you have missed your period (See **Q10**).
- A blue line must be present in the Control Window when you read your result. This line shows that the test has worked.
- If no blue line appears in the Control Window within **10 minutes** refer to **Q7**.

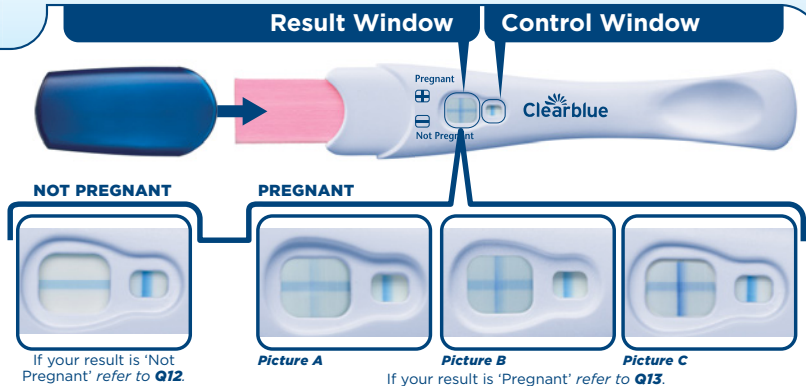

If your result is 'Not Pregnant' refer to **Q12**.

If your result is 'Pregnant' refer to **Q13**.

**It does not matter if one of the lines that make up the '+' symbol is lighter or darker than the other; the result is 'Pregnant'.**

**IMPORTANT!** Read your result within **10 minutes** of doing a test. Disregard any changes to your result after this time.

If you are still unsure of your result refer to **Q8** for full details.

## Questions and Answers

- 1 How accurate is Clearblue® Rapid Detection?**  
Clearblue® Rapid Detection is more than 99% accurate in laboratory tests, **when used from the day of your expected period.\***
- 2 How does Clearblue® Rapid Detection work?**  
When you are pregnant your body produces the pregnancy hormone hCG (human Chorionic Gonadotropin). The amount of hCG in your body increases in the early stages of pregnancy. Clearblue® Rapid Detection can detect tiny amounts of this hormone in your urine. (The sensitivity of this test is 25mIU/ml).
- 3 When can I test with Clearblue® Rapid Detection?**  
Clearblue® Rapid Detection can be used up to 4 days before your expected period. If you test before your expected period and get a 'Not Pregnant' result, there is still a chance that you may be pregnant. See the chart below for results from clinical testing of Clearblue® Rapid Detection with early pregnancy samples.

### Testing Early

The pregnancy hormone increases rapidly in early pregnancy and Clearblue® Rapid Detection can be used to test up to 4 days before you expect your period, which is 5 days sooner than waiting until you miss your period to test. In clinical testing with early pregnancy samples, Clearblue® Rapid Detection gave the following results:

Number of days before the expected period	% of samples from pregnant women giving a 'Pregnant' result
-1	98%
-2	97%
-3	88%
-4	56%

- 4 Do I have to use an early morning urine sample?**  
If you are testing before you expect your period to start, test with your first urine of the day. Otherwise you can test any time of the day. Avoid drinking too much liquid before testing.
- 5 Can any medication or medical conditions affect the result?**  
  - Always read manufacturers' instructions for any medication you are taking before conducting a test.
  - Fertility drugs containing hCG (such as Pregnyl® and Profasi®)\*\* can give misleading results (these fertility drugs are usually given by injection). Testing with Clearblue® Rapid Detection too soon after administration can give a false 'Pregnant' result.
  - Other fertility therapies (such as Clomid\*\*\*), painkillers and hormonal contraceptives (e.g. contraceptive pill) should not affect the result.
  - If you have recently stopped using hormonal contraception or are using fertility therapies like Clomid\*\*\*, your periods may be irregular, leading you to test too soon.
  - If you have recently been pregnant (even if not carried to full term) you may get a false 'Pregnant' result.
  - Ectopic pregnancy, ovarian cysts, menopause and some very rare medical conditions can give misleading results.
  - If you have a 'Pregnant' result it is possible that you later find that you are not pregnant due to natural loss of the pregnancy which can occur in the early stages.
 If you do get unexpected results you should discuss them with your doctor.
- 6 I have used the Pregnancy Test but the Color Change Tip has not turned completely pink. What should I do?**  
If the Color Change Tip has not turned completely pink you may not have applied enough urine. However, if the blue line in the Control Window appears within 10 minutes of performing the test then the test has worked.
- 7 I have used the Pregnancy Test but no blue line has appeared in the Control Window within 10 mins. What should I do?**  
The test has not worked. This may be because:
  - The Color Change Tip was not kept pointing downwards or the Test Stick was not laid flat after urine was applied.
  - Too much or too little urine was used. **You must sample for 5 seconds.**
 You should test again, using a new test stick, taking care to follow the instructions. You may wish to collect a sample of your urine in a clean, dry container and immerse only the Color Change Tip for 5 seconds.

## 8 What if I am unsure of my result?

- For your result to be 'Pregnant' there must be a blue line in the Control Window and a '+' symbol in the Result Window within 10 minutes of performing the test.
- The appearance of the '+' symbol in the Result Window may vary, however, the lines that make up the '+' symbol and the line in the Control Window should be of a similar width (see pictures A-C in the results section).

### Picture A

This denotes a 'Pregnant' result. This is more likely when you are testing before your expected period when your hCG levels may be relatively low.

### Picture B

This is not unusual when you are pregnant and you are testing on or around the day your period is expected as hCG levels may still be relatively low.

### Picture C

This is more likely to occur when you are testing more than a few days after your period was expected as hCG levels are higher. If you are still unsure of your result, you should wait at least 3 days before testing again, taking care to follow instructions.

- For your result to be 'Not Pregnant' there must be a blue line in the Control Window and a '-' (minus) symbol in the Result Window within 10 minutes of performing the test. If your result is 'Not Pregnant' and pregnancy is still suspected, refer to **question 12**.

## 9 What might affect the accuracy of the result?

If you are testing before your expected period the accuracy of Clearblue® Rapid Detection will be lower. If you don't sample your urine for the correct amount of time, then you may not get a reliable result. However, as long as you see a blue line in the Control Window within 10 minutes of performing the test you may rely on the result. If you repeatedly get unexpected results you should check with your doctor. *Also refer to question 5.*

## 10 When can I read the result?

**A 'Pregnant' result may appear in 1 minute when testing from your missed period** (which is the day after your expected period). Make sure a blue line is also present in the control window before reading your result. You **must** wait 3 minutes to confirm a 'Not Pregnant' result, or when testing before your missed period.

## 11 How long will the result last?

The result can be read any time from 3 to 10 minutes. After 10 minutes any change in your result should be disregarded.

## 12 My test says I'm not pregnant. What should I do?

- You may not be pregnant, or the level of pregnancy hormone may not yet be high enough to be detected, or you may have miscalculated the day of your expected period.
- If you tested early, test again when your period is expected.
- If your period is overdue, wait 3 days before testing again. If this test gives you a 'Not Pregnant' result and you still have not had your period, see your doctor.

## 13 My test says I'm pregnant. What should I do?

If your test says you are pregnant you should see your doctor who can advise you on what steps you should take next.

## 14 I have been trying to get pregnant but have not yet succeeded. Is there anything I can do?

You are at your most fertile and therefore most likely to become pregnant, during the days leading up to and including the day of ovulation (when one of your ovaries releases an egg). Clearblue® Easy Ovulation Test is a one-step test stick which predicts ovulation, by identifying changes in your hormone levels. Clearblue® Easy Ovulation Test is as simple to use as a Clearblue® Rapid Detection Pregnancy Test. The Clearblue® Fertility Monitor is the most advanced method to maximize your chances of conceiving. The monitor unmistakably displays your level of fertility every day and more accurately identifies more fertile days than any other method. For more information call the Clearblue® Helpline.

Clearblue® Rapid Detection is specially designed for easy use at home. However, if you have questions about the test, please call the Clearblue® Helpline. A 24 hour, 7 days a week recorded information service is available for your use. In addition, the Clearblue® team is available to answer your questions Monday-Friday 8:30 a.m. - 5:00 p.m. Eastern Standard Time. ☎ **1-800-321-3279** Please have the lot numbers ready from both the outer and inner packaging. Calls are recorded for training and quality control. **Visit us at: [www.clearblueeasy.com](http://www.clearblueeasy.com)**

### Home Pregnancy Test.

For *in vitro* diagnostic use only.  
Store at 36°-86°F (2°-30°C).

**Allow to reach room temperature for 30 minutes prior to testing if stored refrigerated.**  
Do not freeze.

\*99% accurate at detecting the pregnancy hormone. However, some pregnant women may not have detectable amounts of pregnancy hormone in their urine on the first day of the missed period or may have miscalculated the first day of their missed period.

Keep out of reach of children.

Do not use if the foil wrapper containing the test stick is damaged.

Do not use if the test stick is past its expiration date.

Use once.

Made in PRC. Packaged in USA.  
Distributed by Procter & Gamble,  
Cincinnati, OH 45202.

Clearblue® is a trademark of SPD Swiss Precision Diagnostics GmbH (SPD).  
© 2016 SPD. All rights reserved.

Pat. - see  
[www.swissprecisiondiagnostics.com/patents](http://www.swissprecisiondiagnostics.com/patents)

\*\*Pregnyl® is a registered trademark of Organon USA Inc. Profasi® is a registered trademark of Ares Trading S.A.

\*\*\*Clomid® is a registered trademark of Merrell Pharmaceuticals Inc.

The US Surgeon General advises pregnant women to abstain from alcohol consumption as this may lead to harmful effects on the baby such as Fetal Alcohol Syndrome Disorders (FASD). More information is available at [www.surgeongeneral.gov](http://www.surgeongeneral.gov).